

## 868 MHz

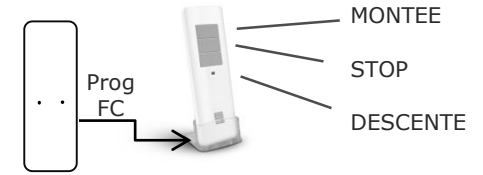

### Programmation émetteur

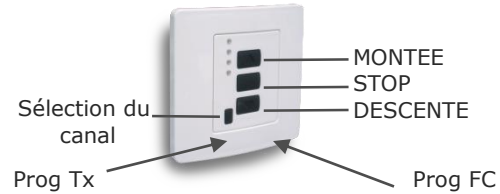
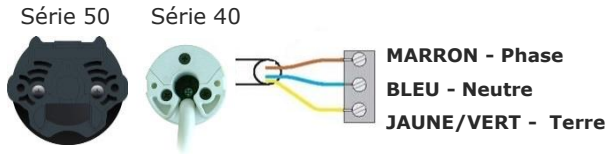
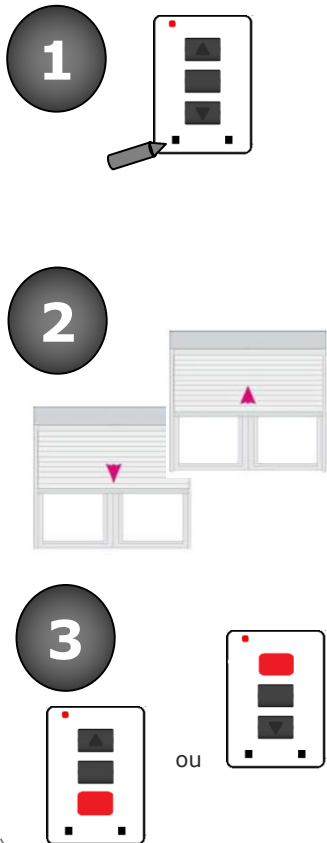

### Programmation fins de course

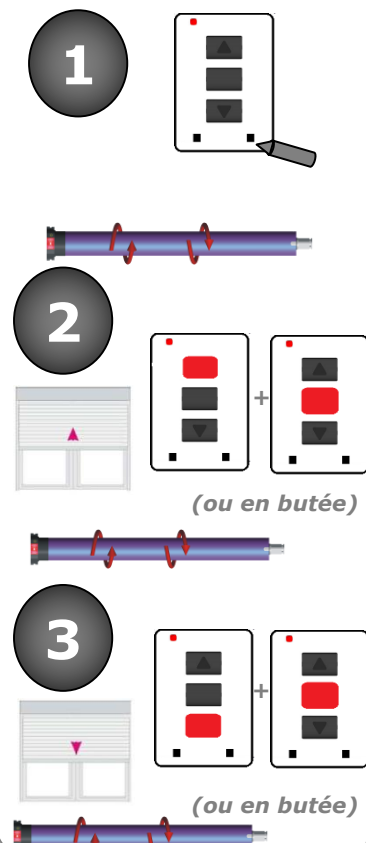

### Position intermédiaire

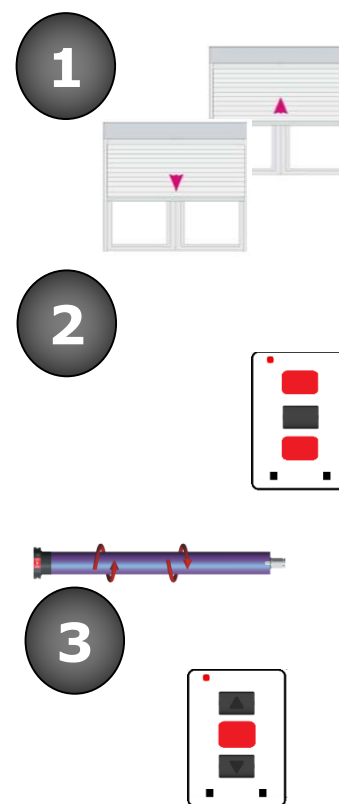

### Ajout d'un émetteur

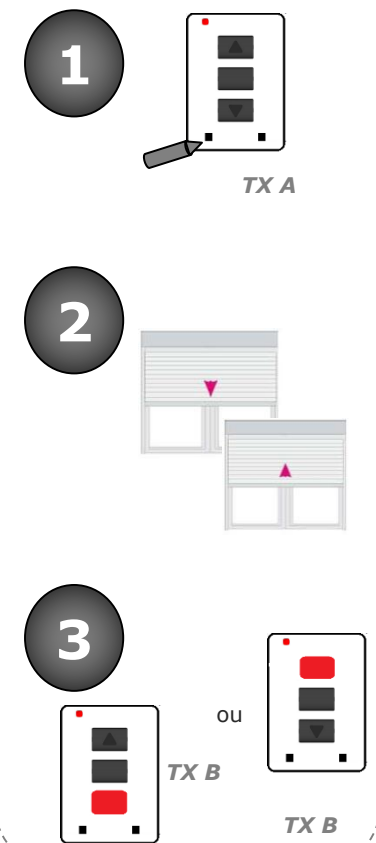

## 868 MHz

*(Uniquement quand l'émetteur associé a été perdu)*

### Effacement émetteur

1

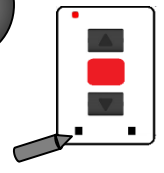

*(en même temps)*

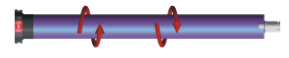

### Remise à zéro de l'émetteur

1

**Alimentation coupée**

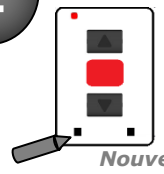

*Nouvel émetteur. Maintenir en même temps*



2

**Maintenir et réalimenter le moteur**

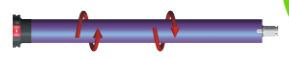

3

**Suivre procédure: programmation émetteur**

### Fin de course haut seulement

1

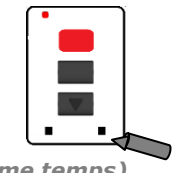

*(en même temps)*

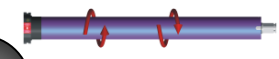

2

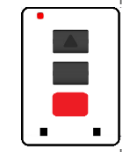
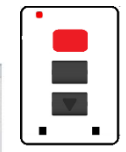
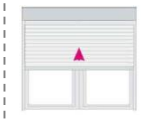

*(ou en butée)*

3

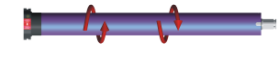
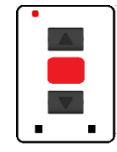

**Vérifier que la descente s'arrête nette et sans aller-retour**

### Fin de course bas seulement

1

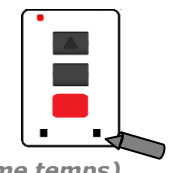

*(en même temps)*

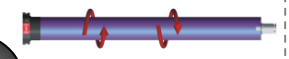

2

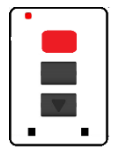
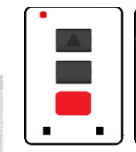

*(ou en butée)*

3

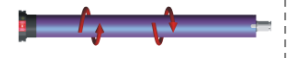
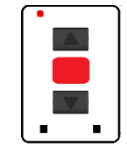

**Vérifier que la descente s'arrête nette et sans aller-retour**